



# INDUSTRIAL UNITS FOR LEASE

**WESTLAKE VILLAGE BUSINESS PARK**  
822 HAMPSIRE RD / 756-780 LAKEFIELD RD / 2630 TOWNSGATE RD  
WESTLAKE VILLAGE, CALIFORNIA

**WESTCORD**  
50 YEARS OF EXCELLENCE

**Tony Principe**  
805.497.4557 x236  
Tony@Westcord.com  
BRE# 01491368

**Jeremy Principe**  
805.497.4557 x236  
Jeremy@Westcord.com  
BRE# 02131156

**Brendan Pagani**  
805.497.4557 x253  
Brendan@Westcord.com  
BRE# 02095300

This information has been furnished from sources which we deem reliable, but for which we assume no liability. The information contained herein is given, in confidence, with the understanding that all negotiations pertaining to this property be handled through the submitting office. All measurements are approximate.

[www.westcord.com](http://www.westcord.com)

# AERIAL OVERVIEW

## WESTLAKE VILLAGE BUSINESS PARK

822 HAMPSHIRE RD / 756-780 LAKEFIELD RD / 2630 TOWNSGATE RD  
WESTLAKE VILLAGE, CALIFORNIA



THOUSAND OAKS  
AUTO MALL

US  
101

WESTLAKE VILLAGE  
BUSINESS PARK

US  
101

HYATT  
HOTEL

TOWNSGATE RD.

WESTLAKE  
PLAZA

TOWNSGATE ROAD

LAKEFIELD ROAD

WESTLAKE BOULEVARD

AGOURA ROAD

HAMPSHIRE ROAD

N

# OVERVIEW

**WESTLAKE VILLAGE BUSINESS PARK**  
822 HAMPSIRE RD / 756-780 LAKEFIELD RD / 2630 TOWNSGATE RD  
WESTLAKE VILLAGE, CALIFORNIA

## AVAILABILITY

SUITE	SIZE	LEASE RATE
766-C	1,898 SF	\$1.95 MG

## LEASE TYPE

Modified Gross. Tenant to pay utilities, janitorial, and a \$0.13 per SF monthly CAM.

## PROPERTY FEATURES

- Well maintained business park with professional environment.
- Prestigious Westlake Village location.
- Centrally located.
- Surrounding amenities including hotels, restaurants, banks, and entertainment related facilities.
- Abundant free parking.

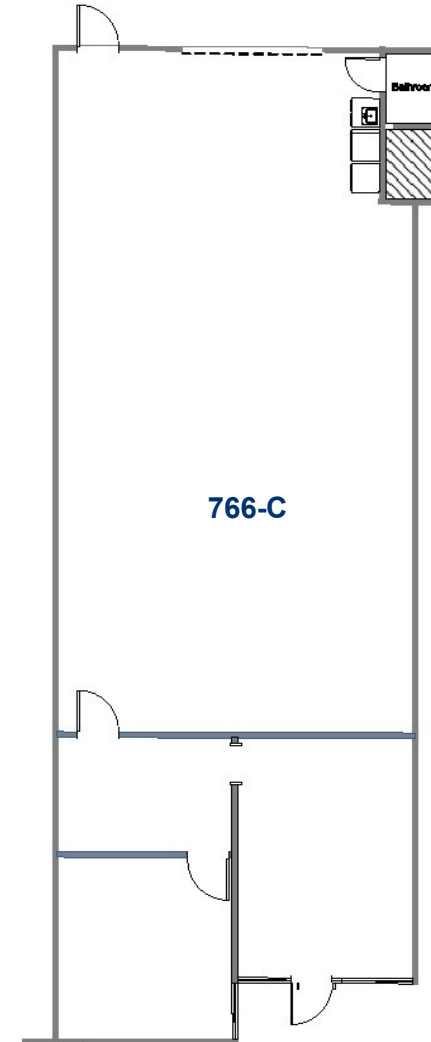

**WESTCORD**  
50 YEARS OF EXCELLENCE

**Tony Principe**  
805.497.4557 x236  
Tony@Westcord.com  
BRE# 01491368

**Jeremy Principe**  
805.497.4557 x236  
Jeremy@Westcord.com  
BRE# 02131156

**Brendan Pagani**  
805.497.4557 x253  
Brendan@Westcord.com  
BRE# 02095300

This information has been furnished from sources which we deem reliable, but for which we assume no liability. The information contained herein is given, in confidence, with the understanding that all negotiations pertaining to this property be handled through the submitting office. All measurements are approximate.

[www.westcord.com](http://www.westcord.com)